

GEMTORTM

... when your life is on the lineTM



The Gemtor Model # VT100 VesTank is designed to be assembled and disassembled without tools. The brass hose fittings and black plastic fill port retaining ring are hand-tightened in the factory and therefore may require re-tightening before first use and periodically thereafter.

The pump is supplied with a black plastic nozzle which provides a non-adjustable stream while the available VT205 brass nozzle adjusts from stream to mist. Care must be taken when switching nozzles as not to lose the Hose Washer.

A ¼ turn valve is attached to the pump. Ensure that the valve is in the Open position while operating the pump.

Two clips (one on each shoulder) are supplied to hold the pump when not in use.

The tank (vest) is designed to be filled through the large fill port located at the center of the back near shoulder level. The vest has a maximum capacity of 8 gallons. Draining the vest can be accomplished either through the fill port or by disconnecting the pump from the vest at the brass quick connect fitting.

Minimal Required Maintenance:

Unscrew the threaded connector nut and remove the piston rod from the brass pump chamber. Lubricate the Piston O-ring, Piston Shaft and the Piston Guide with petroleum jelly, Cosmolube or lithium grease.



VT200 VESTANK Pump - - Parts List

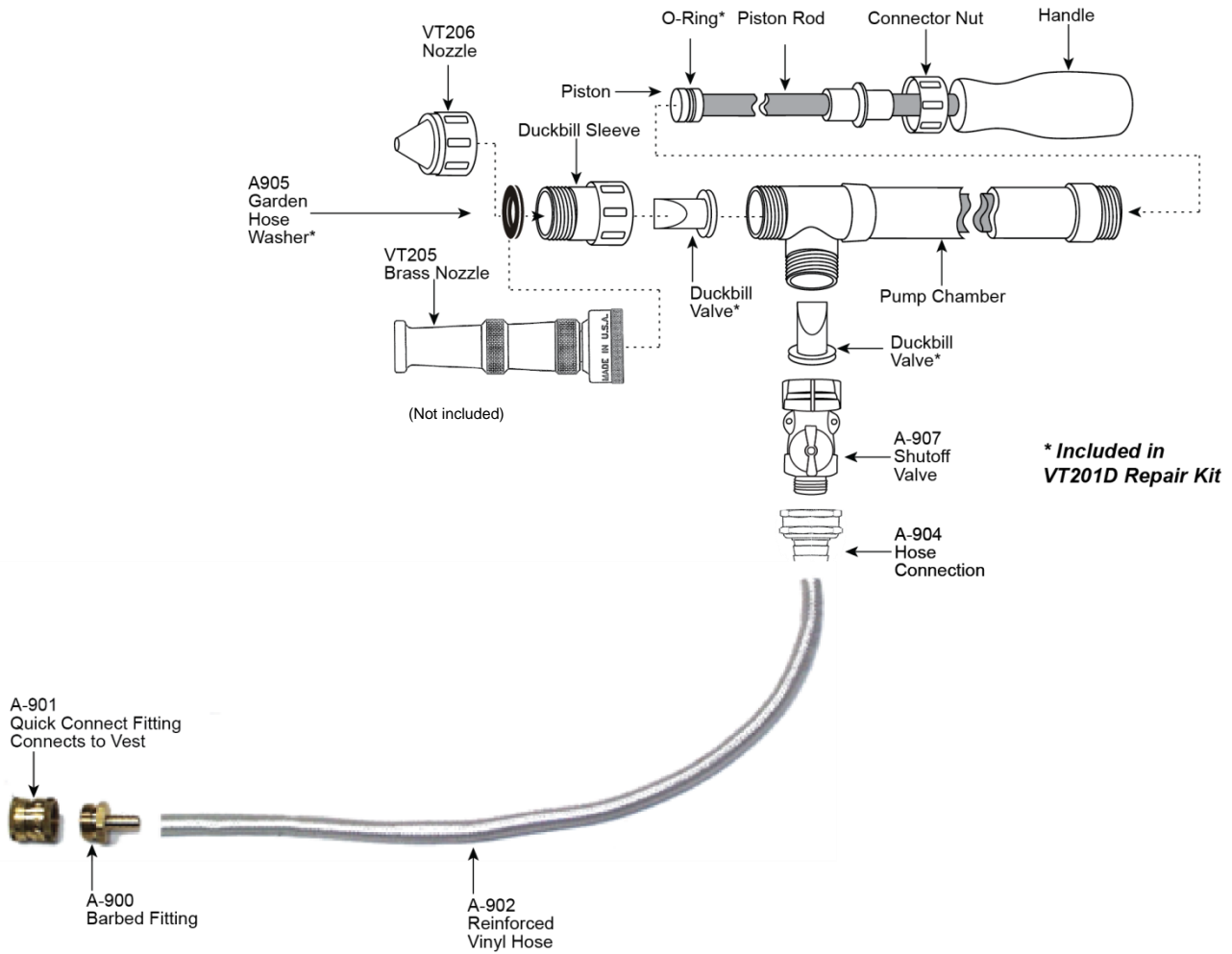

Shutoff Valve Operation

