

GEMTOR™

. . . when your life is on the line™

OWNER'S MANUAL

Installation, Operating, Inspection and Maintenance Instructions

- QP-4 Quadpod
- CSQP-4 Quadpod w/retrieval system
- QP-L Portable Base
- QP-D Rotating Boom



Warning

You must read and fully understand all instructions, or have all instructions explained to you, before attempting to use this device. Equipment must not be installed, operated or inspected by anyone who does not understand this Owner's Manual. Failure to observe these instructions could result in serious injury or death. Training and instruction review should be repeated at regular intervals. Keep these instructions available for immediate reference. If you have any questions regarding these instructions or need additional copies, call Gemtor toll free at 800-405-9048.

DESCRIPTION:

Gemtor Quadpods are designed to be used principally with Sentry or work winches and Sentry self-retracting lifelines. Quadpods provide a convenient, portable attachment point which can be moved from place to place, as needed. The quadpod's legs can be adjusted to accommodate unevenness of footing within reasonable limits.

- A. Portable Base** - The base Model # QP-L) is made of aluminum and steel and has four height adjustable legs (to compensate for uneven terrain. The legs fold for easy transport and storage.
- B. Boom** - The Boom (Model # QP-D) is made of steel, and has on one end a cylinder for attachment to the shaft (2) of the exterior pole of the base. The opposite end of the Boom has two pulleys (5) with a security pin (6) keep the cable from coming off of the pulleys. There are 2 brackets (7 and 8) for the attachment of Gemtor fall protection and recovery systems and winches. Bracket (7) is for the attachment of a Three-Way fall protection and recovery unit (9). Bracket (8) is for the attachment of a Personnel Winch or Work Winch (10). When the Boom is attached to the exterior pole, the Boom can be rotated by an angle of 360 degrees. The screw handle (4) is designed to fix or release the Boom on the extension pole in the necessary position



Gemtor, Inc. • One Johnson Avenue • Matawan, NJ 07747
Phone: 732-583-6200 • 800-405-9048 • Fax: 732-290-9391
Web: www.gemtor.com • Email: sales.info@gemtor.com



IMPORTANT INFORMATION:

Purchased from (Distributor): _____

Address: _____

City: _____ **State** _____ **Zip** _____

Purchase Date: _____

Model Number: _____

Serial Number: _____

Property of:

Keep this information for future reference.

IMPORTANT: Return registration card immediately

SPECIFICATIONS:

Model Number	QP-4	CSQP-4
Description	QP-L (portable base) & QP-D (rotating boom)	Quadpod, Complete w/Retrieval Winch
Maximum static test load	5400 lbs.	5400 lbs.
Working load	310 lbs.	310 lbs.
Head Room	91"	91"
Overall Height	94"	94"
Distance between feet	54"	54"
Reach	26"	26"
Individual leg adjustment increments	infinite	infinite
Size for transport and storage: Base Davit Arm (QP-D) Retrieval Winch (RS3-50)	21" x 60" 17" x 62" N/A	21" x 60" 17" x 62" 14" x 10" x 10"
Weight: Base Davit Arm (QP-D) Retrieval Winch (RS3-50)	75 lbs. 41 lbs. N/A	75 lbs. 41 lbs. 45 lbs.

TRAINING:

The employer shall provide a training program for each employee who might be exposed to fall hazards. The program shall enable each employee to recognize the hazards of falling and shall train each employee in the procedures to be followed in order to minimize these hazards.[OSHA 1926.503(a)(1)]

The employer shall assure that each employee has been trained, as necessary, by a competent person qualified in the following areas:

- (i) The nature of fall hazards in the work area;
- (ii) The correct procedures for erecting, maintaining, disassembling, and inspecting the fall protection systems to be used;
- (iii) The use and operation of guardrail systems, personal fall arrest systems, safety net systems, warning line systems, safety monitoring systems, controlled access zones, and other protection to be used;
- (iv) The role of each employee in the safety monitoring system when this system is used;
- (v) The limitations on the use of mechanical equipment during the performance of roofing work on low-sloped roofs;
- (vi) The correct procedures for the handling and storage of equipment and materials and the erection of overhead protection;
- (vii) The role of employees in fall protection plans;
- (viii) The standards contained in this subpart.[OSHA 1926.503(a)(2)]

The employer shall verify compliance with paragraph (a) of this section by preparing a written certification record. The written certification record shall contain the name or other identity of the employee trained, the date(s) of the training, and the signature of the person who conducted the training or the signature of the employer. If the employer relies on training conducted by another employer or completed prior to the effective date of this section, the certification record shall indicate the date the employer determined the prior training was adequate rather than the date of actual training.[OSHA 1926.503(b)(1)]

INSTALLATION:

1. Position quadpod base alongside manhole or other opening (quadpod will stand in collapsed position).
2. Remove locking pin from center collar (1) and telescope base section (2) so that legs are spread apart as far as possible. Reinsert pin.
3. Place davit arm (3) on top of base section. Davit should turn 360 degrees. Pin may be inserted at 90-degree intervals to lock davit arm in position.
4. Adjust height of each leg to compensate for uneven terrain. Remove pin from quadpod leg near quadpod foot (9), Adjust height to level quadpod, reinsert pin in appropriate hole. Alternatively if your quadpod features screw down leg adjustments, simply crank the screw adjuster up or down to the desired level.

OPERATION:

1. Mount Sentry winch or Sentry fall arrest/retrieval device (4) to bracket (5) on top of davit arm using locking pins, pull or winch cable from the housing of the device and put through pulley (8) at top of davit arm.
2. If using a man rated winch or work winch (6), Mount to accessory mounting bracket (7) on top of davit arm, pull out winch cable from the housing of the device and put through pulley (8) at top of davit arm.
3. If you are using a Sentry self-retracting lifeline, connect the Sentry's bracket to the accessory mounting plate (10) using a locking carabineer.
4. Remove manhole cover, **being sure to avoid opening.**
5. Position quadpod with davit arm over opening.
6. Extract cable from fall protection unit and attach snaphook to fall arrest D-ring on worker's harness.
7. When work is completed, reverse instructions to cover manhole, telescope quadpod and remove from work location.

Note:

- Always use hooks and related equipment, which meet OSHA and ANSI standards.
- Operations should be conducted in accordance with instructions for the fall protection equipment being used and federal, state and local regulations.

INSPECTION:

Equipment must be inspected before each use; if bent, damaged or if parts have been substituted, **DO NOT USE**. Return to Gemtor for reconditioning or repair.

WARNINGS:

- **DO NOT USE IF** The device appears to be damaged.
- **DO NOT** attempt to adjust, repair or modify Gemtor Quadpod; for prompt repair or reconditioning, return the unit to Gemtor Inc., prepaid.
- Do not use for other than intended purpose.
- **DO NOT** exceed maximum recommended working load.
- **NEVER** work above the anchor point.
- **ALWAYS** work directly under the anchor point. Worker must be vertically in line with device to avoid swing-fall injuries (pendulum effect).

IF YOU HAVE ANY QUESTIONS CONCERNING THE CORRECT USAGE OF THIS OR ANY GEMTOR PRODUCT, DO NOT USE, CALL (TOLL FREE) 1-800-405-9048

Do not try to adjust, repair or modify Gemtor quadpods; for prompt service, please contact:

**GEMTOR, INC.
ONE JOHNSON AVENUE
MATAWAN, NJ 07747
732-583-6200**

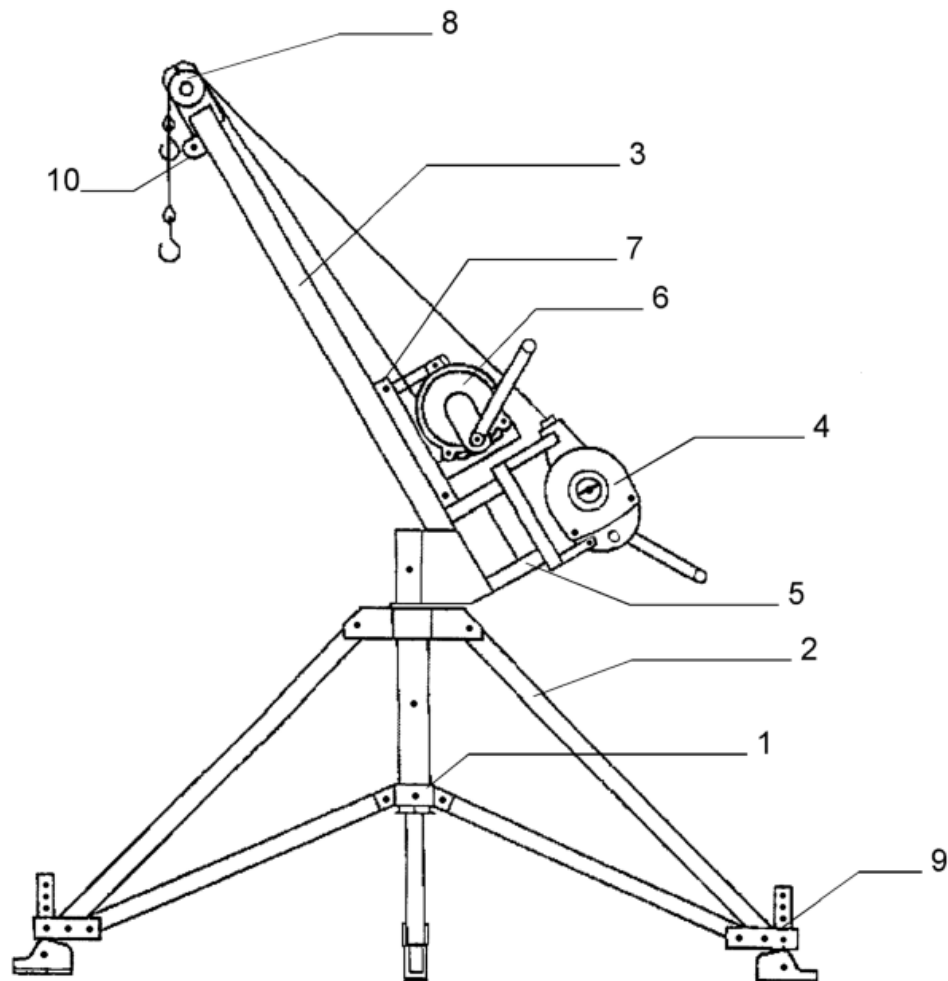

Intentionally Blank

Intentionally Blank

